



serie **CRUSH**

FRANTUMATRICE DI SASSI E ROCCIA
STONES CRUSHER

L'innovativa macchina ideata e costruita per la bonifica di qualsiasi tipo di terreno coltivato e non, con sassi, roccia e ceppi.

The innovative machine designed and built for the reclamation of any type of cultivated land and not, with stones, rocks and stumps.

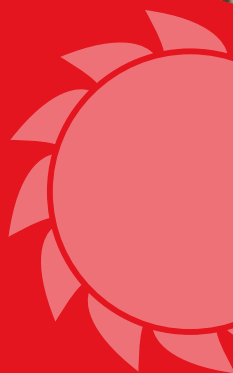

Via Corato SP 238 – Contrada Polisciazzo
70022 Altamura (BA) - ITALY
(+39) 080 314 05 44 - (+39) 334 12 51 509
info@crushingtech.com

WWW.CRUSHINGTECH.COM



CRUSHINGTECH
STONES & FORESTRY MACHINES

MADE IN ITALY



serie CRUSH

FRANTUMATRICE DI SASSI E ROCCIA
STONES CRUSHER

 **CRUSHINGTECH**
STONES & FORESTRY MACHINES

MADE IN ITALY



UTILITÀ UTILITY

- 01** Fresa sassi e roccia di qualsiasi natura
Crushing stones and rock of any type of nature
- 02** Prepara terreni per impianti di vigneti, frutteti, ortaggi e semina, piste antincendio, aree di servizio e piste da sci
Preparing land for vineyards, orchards, vegetables and sowing, fire tracks, service areas and ski slopes

- 03** Fresa terreni con cespugli, arbusti e ceppi
Mulcher land with bushes, shrubs and stumps
- 04** Ripristina strade bianche o linee superficiali dei gasdotti
Maintenance of white roads or surface lines of pipelines
- 05** Stabilizza le strade o altri suoli
Stabilizing roads or other soils

DETTAGLI TECNICI TECHNICAL DETAILS

ALLESTIMENTO STANDARD

- ✓ Rotore a picchi *Fig.1*
- ✓ Trasmissione a catena a bagno d'olio
- ✓ D = doppia trasmissione laterale
- ✓ Griglia posteriore in **Hardox** regolabile idraulicamente tramite il distributore del trattore
- ✓ Le slitte possono essere regolate in altezza
- ✓ Tutte le parti di usura a diretto contatto con sassi e terra sono in **Hardox** e intercambiabili
- ✓ Albero cardano con bullone di sicurezza

STANDARD EQUIPMENT

- ✓ Rotor with peaks *Fig.1*
- ✓ Transmission by chain in oil bath
- ✓ D double side transmission
- ✓ Rear grate in **Hardox** adjustable by the distributor of tractor
- ✓ Side skids adjustable in height
- ✓ All the wearing parts in direct contact with ground are in **Hardox** and interchangeable
- ✓ Drive shaft with safety bolt

TRATTORE RICHIESTO

- ✓ Super riduttore o cambio **VARIO**

TRACTOR

- ✓ *Creep* or *CVT* vario

RICAMBI

- ✓ Picco
- ✓ Rondella
- ✓ Rondella a molla

SPARE PARTS

- ✓ peak
- ✓ washer
- ✓ spring washer

OPZIONI

- ✓ Per un maggiore uso **forestale** è possibile ordinare la macchina con rotore ad **Utensili a Martelli Fig.2**
- ✓ Utensile a Martello
- ✓ Bullone
- ✓ Rondella

OPTION

- ✓ For a major **forestral** use it is possible to order the machine with **Hammers Fig.2**
- ✓ Hammer tools
- ✓ Bolt
- ✓ Washer

Fig.1

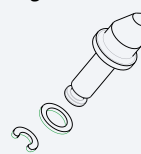
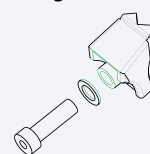

Fig.2



serie CRUSH-10/20



LAVORO WORK

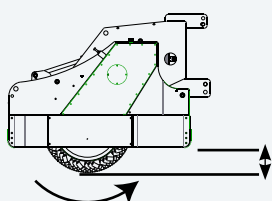

100 mm profondità di lavoro su roccia, asfalto e cemento circa
100 mm working depth on fixed rock, asphalt, concrete approx

200 mm su terreno prelaborato
200 mm on pre worked ground approx

Trattore: con super riduttore o CVT vario
Tractor: creeper or CVT vario

SPECIFICHE TECNICHE TECHNICAL SPECIFICATIONS

MODELLO Model	 HP	PREZZO Price euro	 KG	LARGHEZZA LAVORO Working width mm	LARGHEZZA TOTALE Total width mm	PTO RPM	PICCO ø 22 mm QNT	 UTENSILE A MARTELLO QNT
CR- 80-S	70 / 90		1000	800	1120	540	92	
CR-100-S	80 / 90		1125	1000	1320	540	116	
CR-120-S	90 / 100		1250	1200	1520	540	140	
CR-140-S	100 / 120		1450	1400	1720	1000	164	
CRD-160-S	120 / 140		1900	1600	2050	1000	188	
CRD-180-S	140 / 160		2050	1800	2270	1000	212	
CRD-200-S	160 / 180		2230	2000	2450	1000	236	
CRD-220-S	180 / 200		2500	2200	2650	1000	260	
CRD-240-S	200 / 220		2700	2400	2900	1000	284	
CRD-260-S	220 / 240		2850	2600	3100	1000	308	

serie CRUSH-15/30



LAVORO WORK

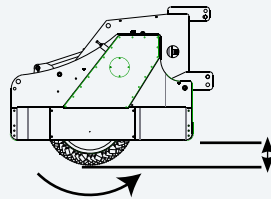

150 mm profondità di lavoro su roccia, asfalto e cemento circa
150 mm working depth on fixed rock, asphalt, concrete approx

300 mm su terreno prelaborato
300 mm on pre worked ground approx

Trattore: con super riduttore o CVT vario
Tractor: creeper or CVT vario

SPECIFICHE TECNICHE TECHNICAL SPECIFICATIONS

MODELLO Model	 HP	PREZZO Price euro	 KG	LARGHEZZA LAVORO Working width mm	LARGHEZZA TOTALE Total width mm	PTO RPM	PICCO ø 25 mm  QNT	UTENSILE A MARTELLO  QNT
CR-80-M	80 / 90		1150	800	1150	540	92	
CR-100-M	90 / 100		1300	1000	1350	540	116	
CR-120-M	100 / 110		1450	1200	1550	540	140	
CRD-140-M	120 / 140		1920	1400	1850	1000	164	
CRD-160-M	140 / 160		2150	1600	2050	1000	188	
CRD-180-M	150 / 170		2450	1800	2250	1000	212	
CRD-200-M	160 / 180		2750	2000	2450	1000	236	
CRD-220-M	200 / 220		3050	2200	2700	1000	260	
CRD-240-M	220 / 240		3380	2400	2900	1000	284	
CRD-260-M	240 / 260		3700	2600	3100	1000	308	

serie CRUSH-20/40



LAVORO
WORK

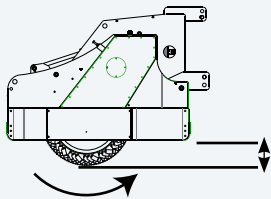

200 mm profondità di lavoro su roccia, asfalto e cemento circa
200 mm working depth on fixed rock, asphalt, concrete approx

400 mm su terreno prelaborato
400 mm on pre worked ground approx

Trattore: con super riduttore o CVT vario
Tractor: creeper or CVT vario

SPECIFICHE TECNICHE TECHNICAL SPECIFICATIONS

MODELLO Model	 HP	PREZZO Price euro	 KG	LARGHEZZA LAVORO Working width mm	LARGHEZZA TOTALE Total width mm	PTO RPM	PICCO ø 25 mm QNT	 UTENSILE A MARTELLO QNT
CRD-140-T	140 / 150		2450	1400	1950	1000	140	
CRD-160-T	160 / 180		2900	1600	2100	1000	164	
CRD-180-T	200 / 220		3350	1800	2370	1000	188	
CRD-200-T	220 / 240		3700	2000	2570	1000	212	
CRD-220-T	260 / 280		3900	2200	2800	1000	236	
CRD-240-T	280 / 300		4100	2400	3000	1000	260	
CRD-260-T	300 / 320		4350	2600	3200	1000	284	

serie CRUSH-25/50



LAVORO WORK

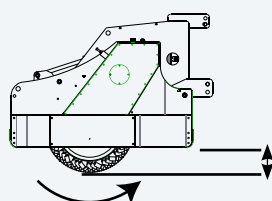





250 mm profondità di lavoro su roccia, asfalto e cemento circa
250 mm working depth on fixed rock, asphalt, concrete approx

500 mm su terreno prelaborato
500 mm on pre worked ground approx

Trattore: con super riduttore o CVT vario
Tractor: creeper or CVT vario

SPECIFICHE TECNICHE TECHNICAL SPECIFICATIONS

MODELLO Model	 HP	PREZZO Price euro	 KG	LARGHEZZA LAVORO Working width mm	LARGHEZZA TOTALE Total width mm	PTO RPM	PICCO ø 25 mm  QNT	UTENSILE A MARTELLO  QNT
CRD-140-P	180 / 200		3400	1400	2000	1000	175	
CRD-160-P	200 / 220		3900	1600	2200	1000	205	
CRD-180-P	220 / 240		4400	1800	2450	1000	235	
CRD-200-P	260 / 300		4800	2000	2600	1000	265	
CRD-220-P	300 / 340		5200	2200	2800	1000	295	
CRD-240-P	340 / 380		5600	2400	3000	1000	325	
CRD-260-P	380 / 440		6000	2600	3200	1000	355	

serie CRUSH-40/70



LAVORO WORK

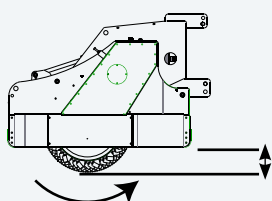

400 mm profondità di lavoro su roccia, asfalto e cemento circa
400 mm working depth on fixed rock, asphalt, concrete approx

700 mm su terreno prelaborato
700 mm on pre worked ground approx

Trattore: con super riduttore o CVT vario
Tractor: creeper or CVT vario

SPECIFICHE TECNICHE TECHNICAL SPECIFICATIONS

MODELLO Model	 HP	PREZZO Price euro	 KG	LARGHEZZA LAVORO Working width mm	LARGHEZZA TOTALE Total width mm	PTO RPM	PICCO ø 25 mm QNT	 UTENSILE A MARTELLO QNT
CR-60-K	160 / 170		3100	600	1100	1000	66	
CR-80-K	180 / 200		3500	800	1300	1000	102	
CR-100-K	220 / 240		4000	1000	1600	1000	138	
CRD-120-K	240 / 260		4900	1200	1860	1000	174	
CRD-140-K	280 / 300		5200	1400	2060	1000	210	
CRD-160-K	300 / 320		5500	1600	2260	1000	246	
CRD-180-K	320 / 360		5800	1800	2460	1000	282	
CRD-200-K	360 / 400		6350	2000	2660	1000	318	
CRD-220-K	450 / 500		7000	2200	2860	1000	354	

serie CRUSH MAGNIFICA 7

LAVORO WORK

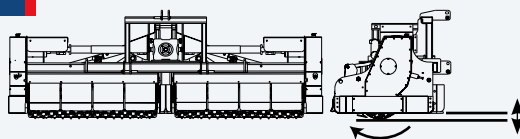

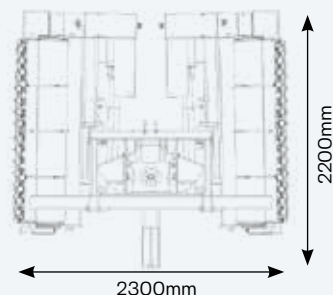
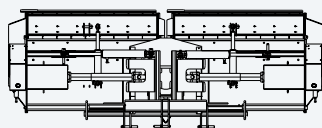

70 mm profondità di lavoro su roccia, asfalto e cemento circa
70 mm working depth on fixed rock, asphalt, concrete approx

140 mm su terreno prelaborato
140 mm on pre worked ground approx



SPECIFICHE TECNICHE TECHNICAL SPECIFICATIONS

MODELLO Model	 HP	PREZZO Price euro	 KG	LARGHEZZA LAVORO Working width mm	LARGHEZZA TOTALE Total width mm	PTO RPM	PICCO ø 22 mm QNT	 UTENSILE A MARTELLO QNT
CR-340-S 160+160	220 / 260		3700	3400	3750	1000	328	
CR-380-S 180+180	260 / 300		4000	3800	4150	1000	340	

ACCESSORI ACCESSORIES

AAIL - Abbatti alberi idraulico con lama livellatrice
Hydraulic pushing tree with leveling blade

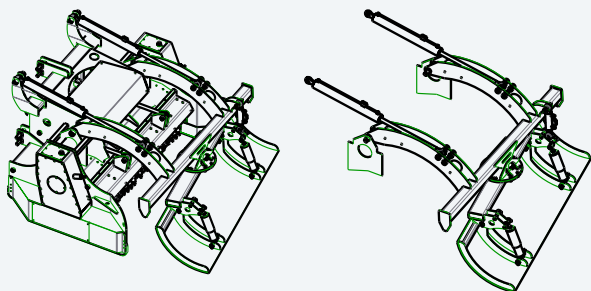

AAI - Abbatti alberi idraulico
Hydraulic pushing tree

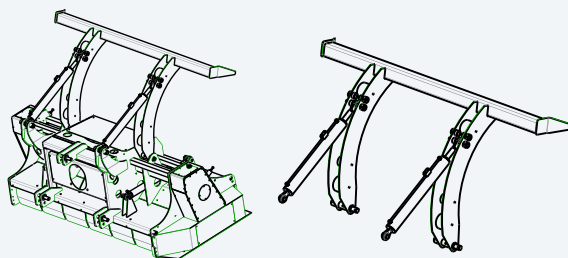

LL - Lama livellatrice
Leveling blade

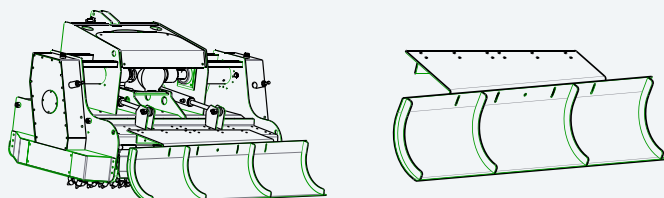

AAM - Abbatti alberi meccanico
Mechanic pushing tree

